

STATE OF NORTH CAROLINA  
DEPARTMENT OF TRANSPORTATION  
HIGHWAY DIVISION 6

**PLANS**  
**Let Date: May 3, 2023**

**CONTRACT ID: DF00436**

**TIP NO.: -----**

**FEDERAL AID NO.: STATE FUNDED**

**WBS ELEMENT NO.: 2023CPT.06.12.20432.1**

**ROUTE NO.: VARIOUS SR**

**LOCATION: VARIOUS**

**COUNTY: HARNETT**

**TYPE OF WORK: ASPHALT SURFACE TREATMENT – DOUBLE SEALS**

**LENGTH OF PROJECT: 31.66 MILES**

**This electronic collection of documents is provided  
for the convenience of the user  
and is Not a Certified Document –**

**The documents contained herein were originally issued  
and sealed by the individuals whose names and license  
numbers appear on each page, on the dates appearing  
with their signature on that page.**

**This file or an individual page  
shall not be considered a certified document.**

# Harnett County Asphalt Surface Treatment

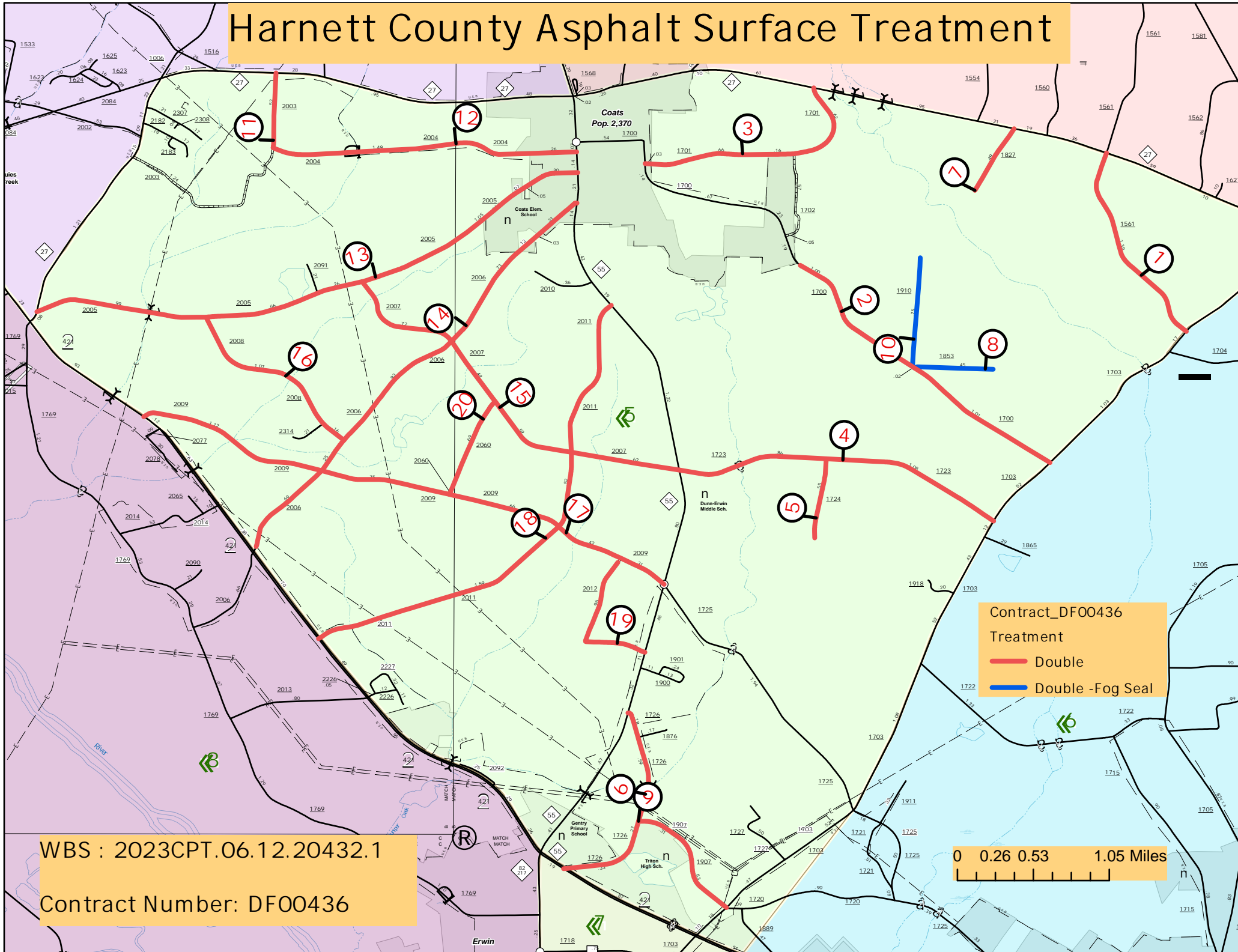



# SIGNING FOR ASPHALT SURFACE TREATMENT

**LEGEND**

- PORTABLE SIGN
- STATIONARY SIGN
- DIRECTION OF TRAFFIC FLOW

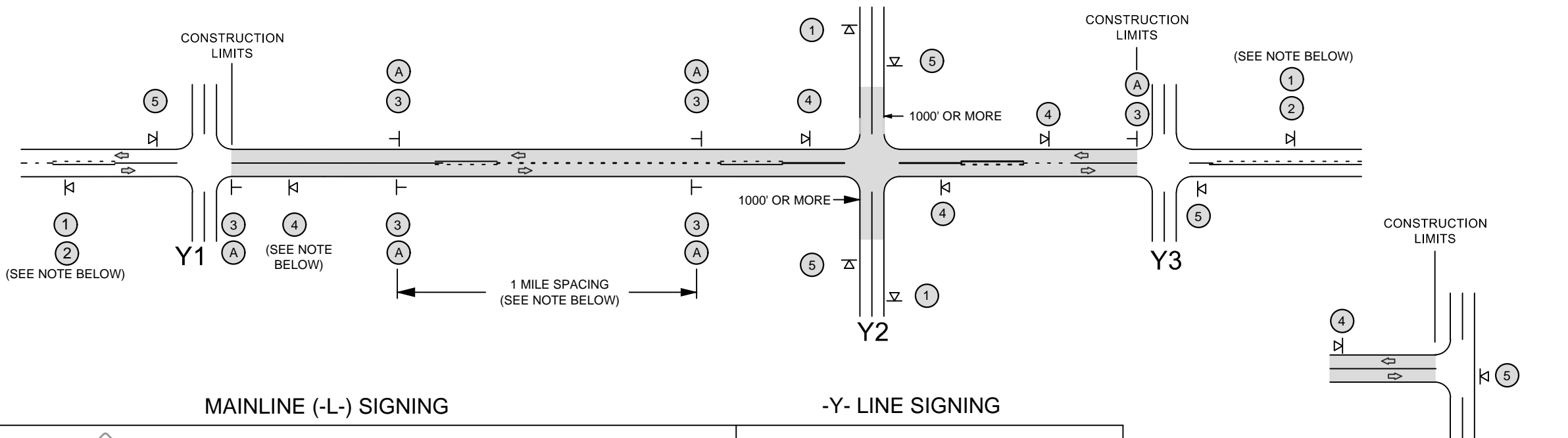

## MAINLINE (-L-) SIGNING

## -Y- LINE SIGNING

SIGNING NOTES AND PLACEMENT PER DIRECTION	<p>① ROAD WORK AHEAD W20-1 48" X 48"</p> <p>② NEXT XX MILES W7-3aP 24" X 18"</p>	<p>- PLACE 1000' PRIOR TO BEGINNING OF CONSTRUCTION LIMITS. ONLY USED ON -Y- LINES IF RESURFACING LIMITS EXTEND 1000' ALONG -Y- LINE.</p> <p>- SIGN #2 ONLY USED WHEN RESURFACING LIMITS ARE 2 OR MORE MILES IN LENGTH. ROUND UP TO THE NEAREST WHOLE NUMBER. DO NOT USE FRACTIONAL OR DECIMAL NUMBERS.</p>
	<p>③ LOOSE GRAVEL W8-7 48" X 48"</p> <p>UNMARKED PAVEMENT SP 48" X 48"</p>	<p>- ALTERNATE THE FOLLOWING TWO SIGNS:</p> <p>- STARTING WITH "LOOSE GRAVEL" (W8-7) FOLLOWED BY "UNMARKED PAVEMENT".</p> <p>- PLACE INITIALLY AT THE CONSTRUCTION LIMITS AND SPACED 1 MILE APART THEREAFTER.</p> <p>- AT TEE INTERSECTIONS INSTALL INITIALLY 0.5 MILE FROM INTERSECTION AND SPACE 1 MILE APART THEREAFTER.</p>
	<p>A SPEED LIMIT 35 W13-1P 18" X 18"</p>	<p>PLACE INITIALLY AT THE CONSTRUCTION LIMITS AND SPACED 1 MILE APART THEREAFTER. IF NO -Y- LINES EXIST, PLACE 2ND SET 1/2 MILE FROM THE CONSTRUCTION LIMITS AND THEN SPACE 1 MILE THEREAFTER. SPEED LIMIT SIGN MAY BE PLACED ON SAME POST AS LOOSE GRAVEL SIGN, IF DESIRED.</p>
	<p>④ ROAD UNDER CONST SP 13106 48" X 48"</p>	<p>- THESE ARE FOR -Y- LINES THAT ARE "THROUGH" ROADWAYS. DEAD END AND SUBDIVISION ROADS ARE NOT "THROUGH" ROADWAYS.</p> <p>- INSTALL 500' +/- FROM EACH -Y- LINE APPROACH AS SHOWN ABOVE.</p> <p>- FOR MULTIPLE -Y- LINES THAT ARE SEPARATED BY 0.25 MILES OR LESS, TREAT AS A SINGLE UNIT AND INSTALL WITHIN 500' OF EACH APPROACH.</p> <p>- A MAXIMUM OF 2 SIGN SETS PER MILE. DO NOT INSTALL WHEN -Y- LINES ARE WITHIN 0.5 MILES FROM "END ROAD WORK" SIGN.</p>
	<p>⑤ END ROAD WORK G20-2 A 48" X 24"</p>	<p>PLACE 500' FOLLOWING THE END OF CONSTRUCTION LIMITS OR AS SHOWN WHEN WORK ENDS AT A 3-WAY TEE INTERSECTION.</p>

STATIONARY SIGNING NOT REQUIRED FOR THE FOLLOWING -Y- LINE CONDITIONS:

- LESS THAN 1000' OF RESURFACING ALONG -Y- LINE
- SUBDIVISION ROADS
- DEAD END ROADS

WHEN PAVING/CONSTRUCTION ACTIVITIES PROCEED ACROSS AN UNSIGNED -Y- LINE, PORTABLE ADVANCE WARNING SIGNS SHALL BE USED ALONG THE -Y- LINE AS SHOWN BELOW. REMOVE UPON COMPLETION OF WORK.

W20-1 48" X 48"

PLACED 500' IN ADVANCE OF FLAGGER.

W20-7 A 48" X 48"

PLACED 250' IN ADVANCE OF FLAGGER.

**NOTE:**  
IT IS THE CONTRACTOR'S RESPONSIBILITY TO ENSURE THE PROPER PLACEMENT AND LOCATION OF WORK ZONE SIGNING PER THE STANDARD DRAWING. NCDOT HAS THE RIGHT TO INSPECT THE PLANNED LOCATIONS AND REQUIRE ADJUSTMENT BY THE CONTRACTOR, AS NEEDED, OR AS DIRECTED BY THE ENGINEER.

**MAPS LESS THAN 2 MILES**

FOR AST RESURFACING MAPS WITH CONSTRUCTION LIMITS LESS THAN 2 MILES IN LENGTH, USE A STATIONARY "LOOSE GRAVEL" SIGN AT THE BEGINNING CONSTRUCTION LIMIT FOLLOWED BY AN "UNMARKED PAVEMENT" SIGN MIDWAY THROUGH AND AN "END ROAD WORK" SIGN AT THE END CONSTRUCTION LIMIT.

REVISED - 12-13-2018

NCDOT - DIVISION 6

ADVANCE WARNING SIGNS FOR 2-LANE ROADWAY ASPHALT SURFACE TREATMENT

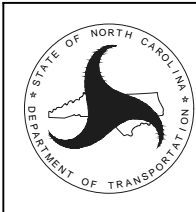

# SUMMARY OF QUANTITIES

											PROJECT NO.		SHEET NO.	TOTAL NO.
											2023CPT.06.12.20432.1			
PROJECT NO	COUNTY	MAP NO	ROUTE	DESCRIPTION	TYP NO	LANES	LANE TYPE	LENGTH		1803500000-E	1820000000-E	1838000000-E	4413000000-E	4457000000-N
								MI	FT	ASPHALT SURFACE TREATMENT, DOUBLE SEAL	ASPHALT SURFACE TREATMENT, FOG SEAL	EMULSION FOR ASPHALT SURFACE TREATMENT	WORK ZONE ADVANCE/GENERAL WARNING SIGNING	TEMPORARY TRAFFIC CONTROL
										SY	SY	GAL	SF	LS
2023CPT.06.12.20432.1	Harnett	1	SR-1561 / BAILEY RD	FROM NC 27 TO SR 1703	1	2	2WU	1.39	20	16,321		9,956	223	1
<b>TOTAL FOR MAP NO. 1</b>								<b>1.39</b>		<b>16,321</b>		<b>9,956</b>	<b>223</b>	<b>1</b>
2023CPT.06.12.20432.1	Harnett	2	SR-1700 / CANE MILL RD	FROM SR 1703 TO CITY LIMITS	1	2	2WU	2	20	23,467		14,315	320	
<b>TOTAL FOR MAP NO. 2</b>								<b>2</b>		<b>23,467</b>		<b>14,315</b>	<b>320</b>	
2023CPT.06.12.20432.1	Harnett	3	SR-1701 / DELMA GRIMES RD	FROM NC 27 TO SR 1700	1	2	2WU	1.47	20	17,260		10,529	235	
<b>TOTAL FOR MAP NO. 3</b>								<b>1.47</b>		<b>17,260</b>		<b>10,529</b>	<b>235</b>	
2023CPT.06.12.20432.1	Harnett	4	SR-1723 / TURLINGTON RD	FROM SR 1703 TO NC 55	1	2	2WU	1.94	20	22,751		13,878	310	
<b>TOTAL FOR MAP NO. 4</b>								<b>1.94</b>		<b>22,751</b>		<b>13,878</b>	<b>310</b>	
2023CPT.06.12.20432.1	Harnett	5	SR-1724 / DANIELS RD	FROM SR 1723 TO END MAINT	1	2	2WU	0.55	20	6,453		3,936	88	
<b>TOTAL FOR MAP NO. 5</b>								<b>0.55</b>		<b>6,453</b>		<b>3,936</b>	<b>88</b>	
2023CPT.06.12.20432.1	Harnett	6	SR-1726 / MAYNARD LAKE RD	FROM US 421 TO NC 55	1	2	2WU	1.39	20	16,356		9,977	223	
<b>TOTAL FOR MAP NO. 6</b>								<b>1.39</b>		<b>16,356</b>		<b>9,977</b>	<b>223</b>	
2023CPT.06.12.20432.1	Harnett	7	SR-1827 / SKEET RANGE RD	FROM NC 27 TO END PVMT	1	2	2WU	0.48	20	5,632		3,436	77	
<b>TOTAL FOR MAP NO. 7</b>								<b>0.48</b>		<b>5,632</b>		<b>3,436</b>	<b>77</b>	
2023CPT.06.12.20432.1	Harnett	8	SR-1853 / MANN RD	FROM SR 1700 TO END PVMT	2	2	2WU	0.45	20	5,280	5,280.00	3,221	72	
<b>TOTAL FOR MAP NO. 8</b>								<b>0.45</b>		<b>5,280</b>	<b>5,280.00</b>	<b>3,221</b>	<b>72</b>	
2023CPT.06.12.20432.1	Harnett	9	SR-1907 / ERWIN ACCESS RD	FROM SR 1726 TO SR 1703	1	2	2WU	0.84	20	9,856		6,012	134	
<b>TOTAL FOR MAP NO. 9</b>								<b>0.84</b>		<b>9,856</b>		<b>6,012</b>	<b>134</b>	
2023CPT.06.12.20432.1	Harnett	10	SR-1910 / OAK VALLEY FARM RD	FROM SR 1853 TO END PVMT	2	2	2WU	0.75	20	8,800	8,800.00	5,368	120	
<b>TOTAL FOR MAP NO. 10</b>								<b>0.75</b>		<b>8,800</b>	<b>8,800.00</b>	<b>5,368</b>	<b>120</b>	
2023CPT.06.12.20432.1	Harnett	11	SR-2003 / MCLAMB RD	FROM NC 27 TO SR 2004	1	2	2WU	0.52	20	6,054		3,693	83	
<b>TOTAL FOR MAP NO. 11</b>								<b>0.52</b>		<b>6,054</b>		<b>3,693</b>	<b>83</b>	
2023CPT.06.12.20432.1	Harnett	12	SR-2004 / W WASHINGTON ST	FROM SR 2003 TO NC 55	1	2	2WU	1.75	20	20,533		12,525	280	
<b>TOTAL FOR MAP NO. 12</b>								<b>1.75</b>		<b>20,533</b>		<b>12,525</b>	<b>280</b>	
2023CPT.06.12.20432.1	Harnett	13	SR-2005 / W HAMER ST	FROM NC 27 TO NC 55	1	2	2WU	3.38	20	39,623		24,170	540	
<b>TOTAL FOR MAP NO. 13</b>								<b>3.38</b>		<b>39,623</b>		<b>24,170</b>	<b>540</b>	
2023CPT.06.12.20432.1	Harnett	14	SR-2006 / CRAWFORD RD	FROM NC 55 TO US 421	1	2	2WU	3.03	18	31,997		19,518	485	
<b>TOTAL FOR MAP NO. 14</b>								<b>3.03</b>		<b>31,997</b>		<b>19,518</b>	<b>485</b>	
2023CPT.06.12.20432.1	Harnett	15	SR-2007 / CLAYHOLE RD	FROM SR 2005 TO NC 55	1	2	2WU	2.42	20	28,430		17,342	388	
<b>TOTAL FOR MAP NO. 15</b>								<b>2.42</b>		<b>28,430</b>		<b>17,342</b>	<b>388</b>	
2023CPT.06.12.20432.1	Harnett	16	SR-2008 / HARVELL RD	FROM SR 2005 TO SR 2006	1	2	2WU	1.23	20	14,420		8,796	197	
<b>TOTAL FOR MAP NO. 16</b>								<b>1.23</b>		<b>14,420</b>		<b>8,796</b>	<b>197</b>	
2023CPT.06.12.20432.1	Harnett	17	SR-2009 / PROSPECT CHURCH RD	FROM NC 55 TO US 421	1	2	2WU	3.25	20	38,180		23,290	521	
<b>TOTAL FOR MAP NO. 17</b>								<b>3.25</b>		<b>38,180</b>		<b>23,290</b>	<b>521</b>	
2023CPT.06.12.20432.1	Harnett	18	SR-2011 / ERWIN CHAPEL RD	FROM NC 55 TO US 421	1	2	2WU	3.2	20	37,594		22,932	513	
<b>TOTAL FOR MAP NO. 18</b>								<b>3.2</b>		<b>37,594</b>		<b>22,932</b>	<b>513</b>	
2023CPT.06.12.20432.1	Harnett	19	SR-2012 / DUKE RD	FROM NC 55 TO SR 2009	1	2	2WU	0.93	20	10,912		6,656	149	
<b>TOTAL FOR MAP NO. 19</b>								<b>0.93</b>		<b>10,912</b>		<b>6,656</b>	<b>149</b>	
2023CPT.06.12.20432.1	Harnett	20	SR-2060 / W TART RD	FROM SR 2009 TO SR 2007	1	2	2WU	0.69	20	8,096		4,939	110	
<b>TOTAL FOR MAP NO. 20</b>								<b>0.69</b>		<b>8,096</b>		<b>4,939</b>	<b>110</b>	
<b>TOTAL FOR PROJ NO. 2023CPT.06.12.20432.1</b>								<b>31.66</b>		<b>368,015</b>	<b>14,080.00</b>	<b>224,489</b>	<b>5,068</b>	<b>1.000</b>
<b>GRAND TOTAL</b>								<b>31.66</b>		<b>368,015</b>	<b>14,080.00</b>	<b>224,489</b>	<b>5,068</b>	<b>1.000</b>